

**FORM AND FUNCTION**

- Sleek, low profile housing
- Spec grade performance
- Engineered for optimum thermal management
- L70 480,000
- Reduces energy consumption and costs up to 65%

**CONSTRUCTION**

- Die Cast Aluminum
- Internal cooling fins, Finite Element Analysis (FEA) designed
- Corrosion resistant external hardware
- One-piece silicone gasket ensures IP-65 seal for electronics compartment
- Two-piece silicone Micro Optic system ensures IP-67 level seal around each PCB
- Silicone Micro Optics: Recessed, full cutoff, vandal resistant and non-yellowing
- Dark Sky Compliant

**FINISH**

- 3-5 mils electrostatic powder coat.
- NLS' standard high-quality finishes prevent corrosion protects against and extreme environmental conditions

**WARRANTY**

Five-year standard warranty



**LISTINGS**

- Certified to UL 1598
- UL 8750
- CSA C22.2 No. 250.0
- DesignLights Consortium® (DLC)
- DesignLights Consortium Premium® (DLCP)
- IP65/ IP67 Rated



**LED WATTAGE CHART**

	16L	32L
350 milliamps	19w	-
700 milliamps	37w	71w

Project Name:

Type:

Cat #	Light Dist.	No. of LEDs	Milliamp	Kelvin	Volts	Mounting	Color	Options
SHIP FLEX NV-W (FLX-NV-W)	Type 2 (T2)	16 (16L)	350 (35)	3000K (30K)	120-277 (UNV)	Wall Mount (WM)	Bronze (BRZ)	Nema 7-Pin Receptacle (PE7) <i>*Requires Deep Back Box</i>
	Type 3 (T3)	32 (32L)	<i>*16L Only</i> 700 (7)	4000K (40K)	347-480 (HV)			Photocell + Receptacle (PCR)
	Type 4 (T4)		1000 (1A) <i>*16L Only</i>	5000K (50K)				Receptacle + Shorting Cap (PER)
			1050 (1) <i>*32L Only</i>					FSP-211 with Motion Sensor (UNV) (FSP-8) *8' & Below Heights (FSP-20) *9'-20" Heights
								FSP211 Remote (FSIR)
								House Side Shield (HSS)

## ELECTRICAL

- 120-277 Volts (UNV)
- 0-10V dimming driver by Philips Advance
- Driver power factor at maximum load is  $\geq .95$ , THD maximum load is 15%
- All internal wiring UL certified for 600 VAC and 105°C
- All drivers, controls, and sensors housed in enclosed IP-65 compartment
- Lumileds Luxeon MX LED's
- CRI >70 MIN.
- Color temperatures: 3000K, 4000K, 5000K

## OPTIONS

### CONTROLS

- **DIMMING CONTROL (DCX)**—Passive infrared (PIR) sensor providing multi-level control based on motion/daylight contribution.
  - All control parameters adjustable via wireless configuration remote storing and transmitting sensor profiles.
  - DC8 mounting heights 8 feet and below
  - DC20 mounting heights 9-20 feet
  - DC40 mounting heights 21-40 feet.
  - Includes 5 dimming event cycles, 0-10V dimming with motion sensing, reprogrammable in the field.
- **NEMA 7-PIN RECEPTACLE (PE7)**—An ANSI C136.41-2013 receptacle provides electrical and mechanical interconnection between photo control cell and luminaire. Dimming receptacle available two or four dimming contacts supports 0-10 VDC dimming methods or Digital Addressable Lighting Interface (DALI), providing reliable power interconnect.

### OPTICS

Silicone optics high photothermal stability and light output provides higher powered LEDs with minimized lumen depreciation LED life. UV and thermal stability with scratch resistance increases exterior application durability.

- IES Types

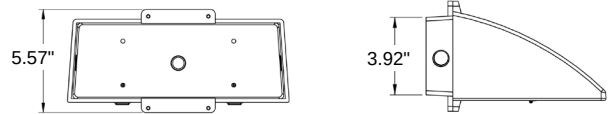
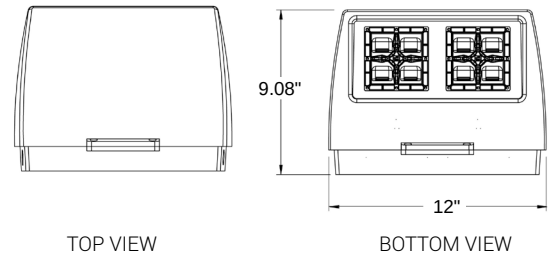
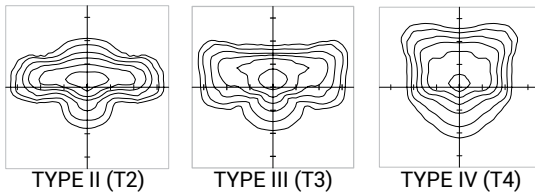

**Weight: 7.2 lbs**

### 7-PIN EXTENSION BOX DIMENSIONS

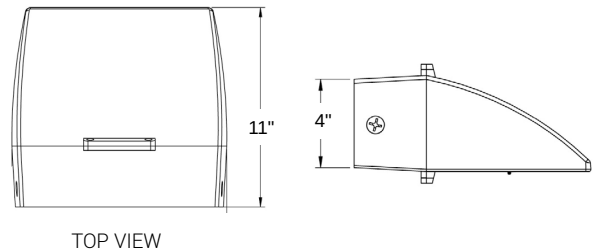

### MOUNTING HOLE

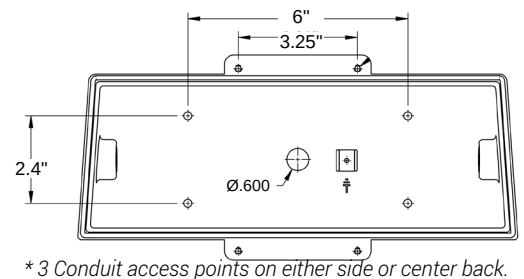

### MOTION SENSOR PLACEMENT



<b>LUMENS</b>							
<b>PART NUMBER</b>	<b>T2</b>	<b>LM/W</b>	<b>T3</b>	<b>LM/W</b>	<b>T4</b>	<b>LM/W</b>	<b>W</b>
NV-W 16L-35-30K	2470	130	2499	132	2470	130	19
NV-W 16L-35-40K	2618	138	2648	139	2618	138	19
NV-W 16L-35-50K	2618	138	2648	139	2618	138	19
NV-W 16L-7-30K	4388	119	4432	120	4388	119	37
NV-W 16L-7-40K	4651	126	4698	127	4651	126	37
NV-W 16L-7-50K	4651	126	4698	127	4651	126	37
NV-W 32L-7-30K	9010	127	9100	128	9010	127	71
NV-W 32L-7-40K	9550	135	9646	136	9550	135	71
NV-W 32L-7-50K	9550	135	9646	136	9550	135	71

<b>BUG RATINGS</b>				
<b>PART NUMBER</b>	<b>T2</b>	<b>T3</b>	<b>T4</b>	<b>W</b>
NV-W-16L-35-30K	B1-U0-G1	B1-U0-G1	B1-U0-G1	19
NV-W-16L-35-40K	B1-U0-G1	B1-U0-G1	B1-U0-G1	19
NV-W-16L-35-50K	B1-U0-G1	B1-U0-G1	B1-U0-G1	19
NV-W-16L-7-30K	B1-U0-G1	B1-U0-G1	B1-U0-G1	37
NV-W-16L-7-40K	B1-U0-G1	B1-U0-G1	B1-U0-G1	37
NV-W-16L-7-50K	B1-U0-G1	B1-U0-G1	B1-U0-G1	37
NV-W-32L-7-30K	B2-U0-G2	B2-U0-G2	B2-U0-G2	71
NV-W-32L-7-40K	B2-U0-G2	B2-U0-G2	B2-U0-G2	71
NV-W-32L-7-50K	B2-U0-G2	B2-U0-G2	B2-U0-G2	71

**L70 DATA**

<b>TEMP.</b>	<b>NV-W</b>
	<b>L70 (16L-1050mA)</b>
<b>60.2°C</b>	483,000

<b>TEMP.</b>	<b>NV-W</b>
	<b>L70 (32L-700mA)</b>
<b>63°C</b>	483,000